

PARTS

(1) Hardware

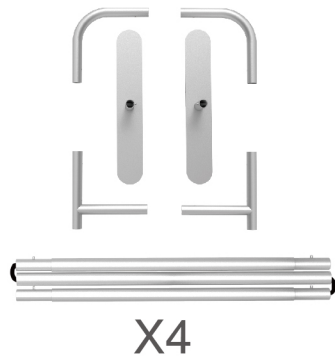

(2) Graphic printing fabric banner



(3) LED Light
Light Clips



STEP 01

To connect the poles according to the labellings

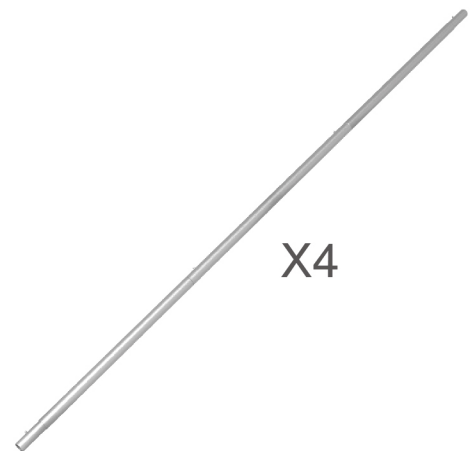
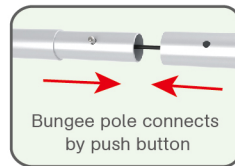
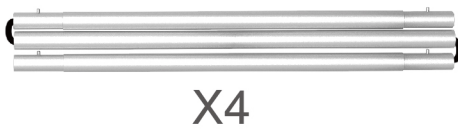

STEP 02

Connect the support poles .

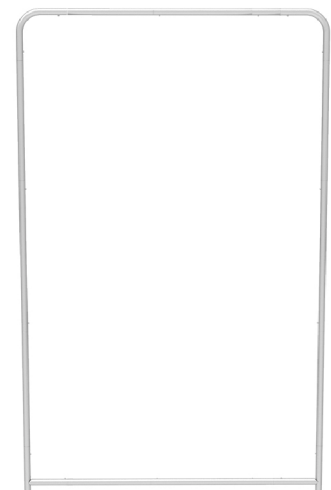
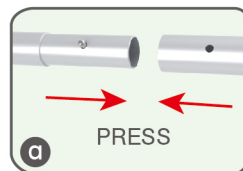
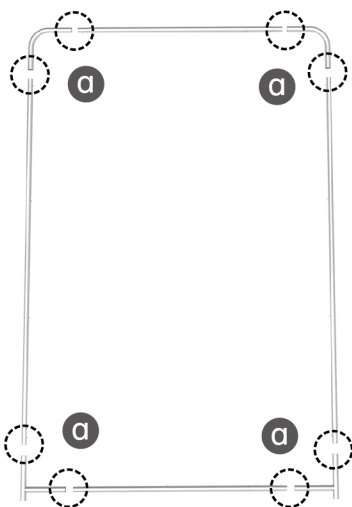

PARTS

STEP 03

To slide the fabric banner on the frame from top and zip up at bottom

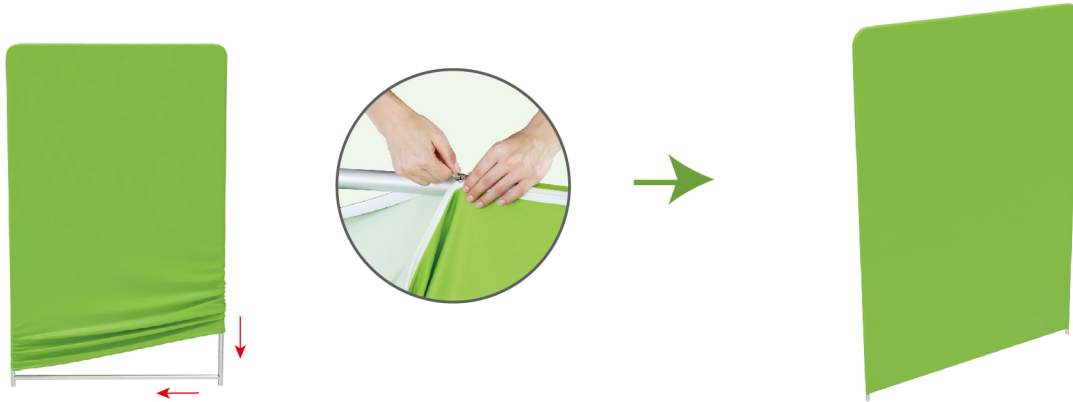

STEP 04

To assemble the stand feet in position

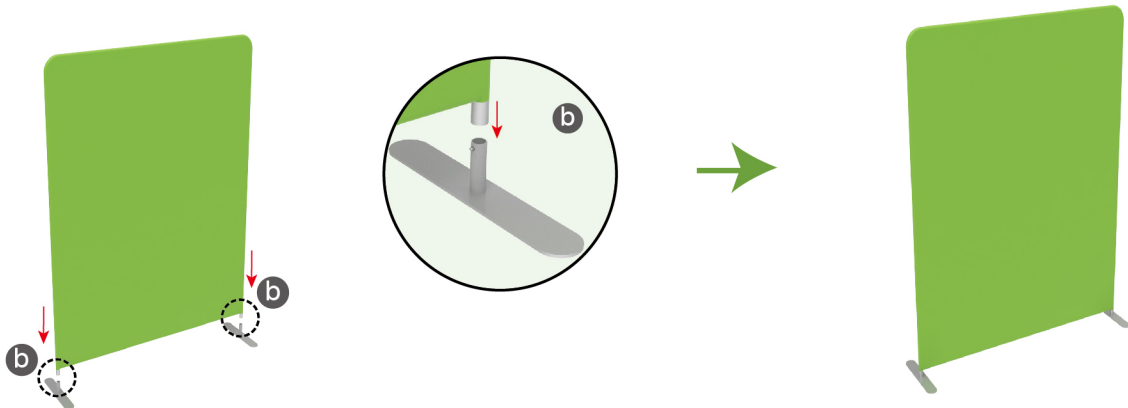

PARTS

(1) Hardware

(2) Graphic printing fabric banner



STEP 01

To connect the poles according to the labellings

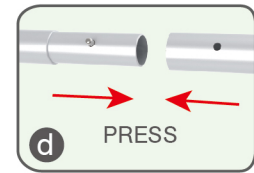
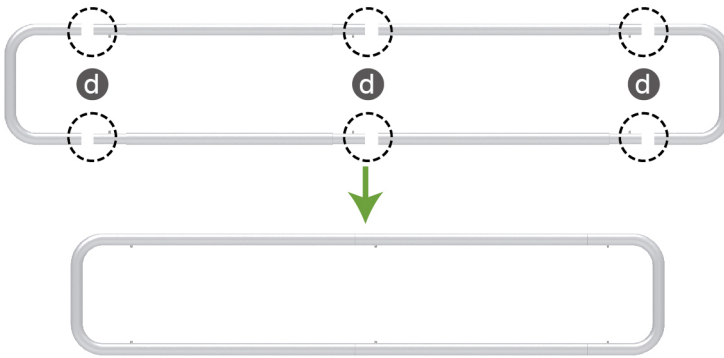

STEP 02

To slide the fabric banner on the frame from side and zip up at side

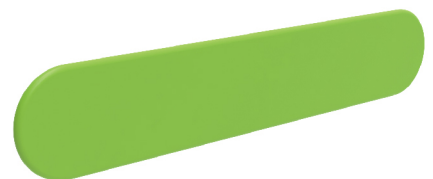
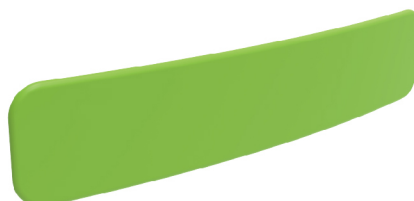
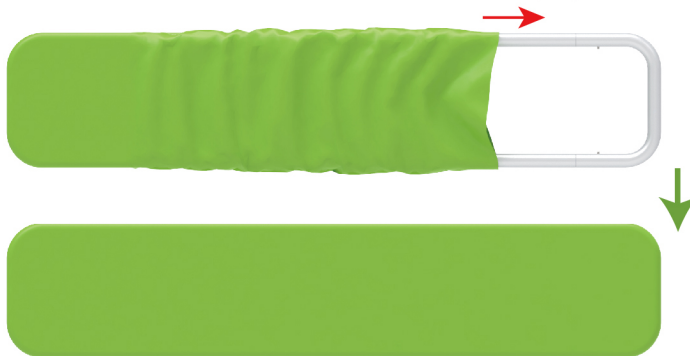

PARTS

Booth Set

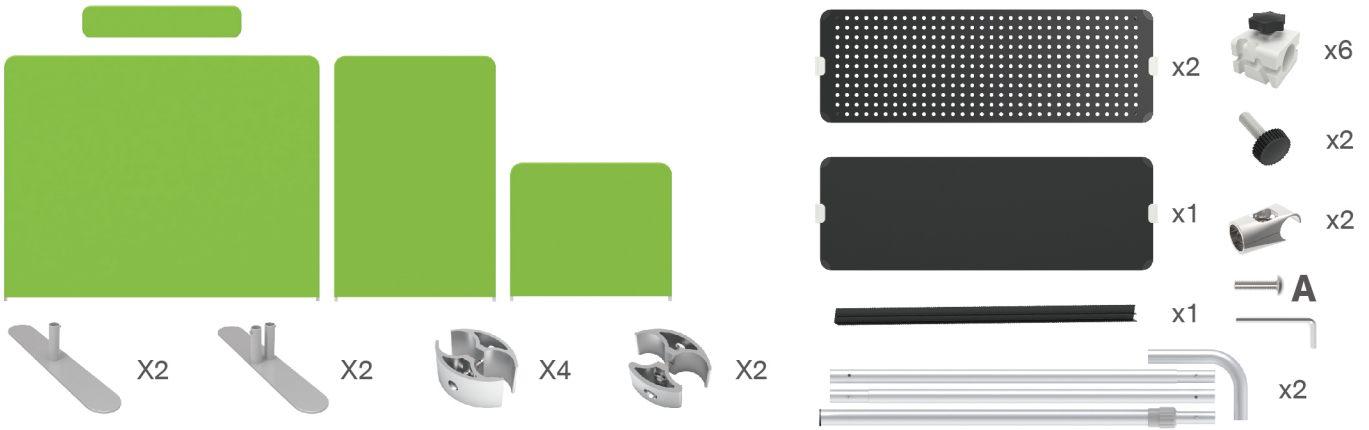

STEP 01

To assemble the stand feet in position

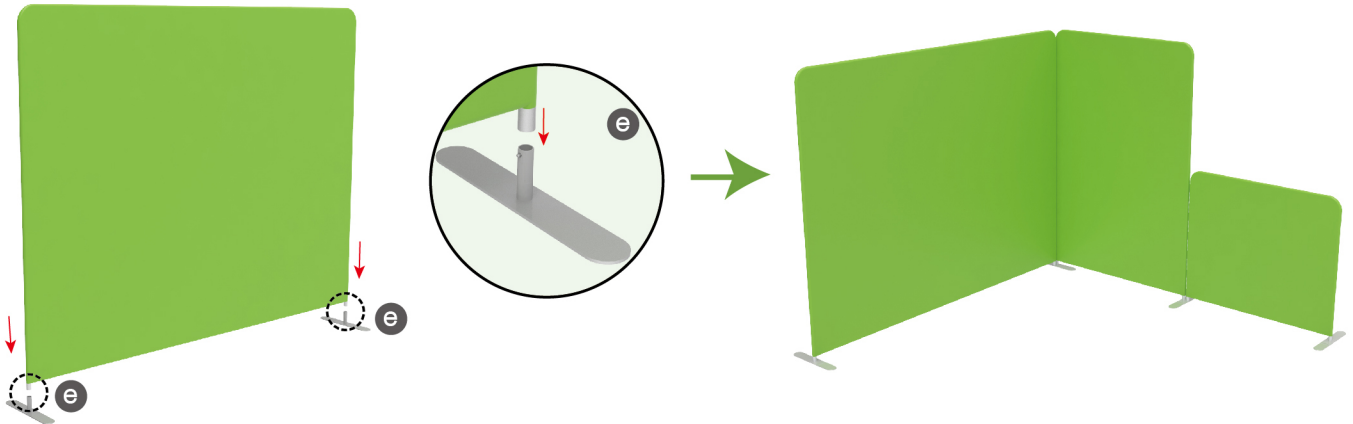

STEP 02

To slide the shelves clip onto the poles and loose the screw of clamp a bit then clip to the top of backwall, afterwards, install the pegboards in position and adjust the height of poles properly

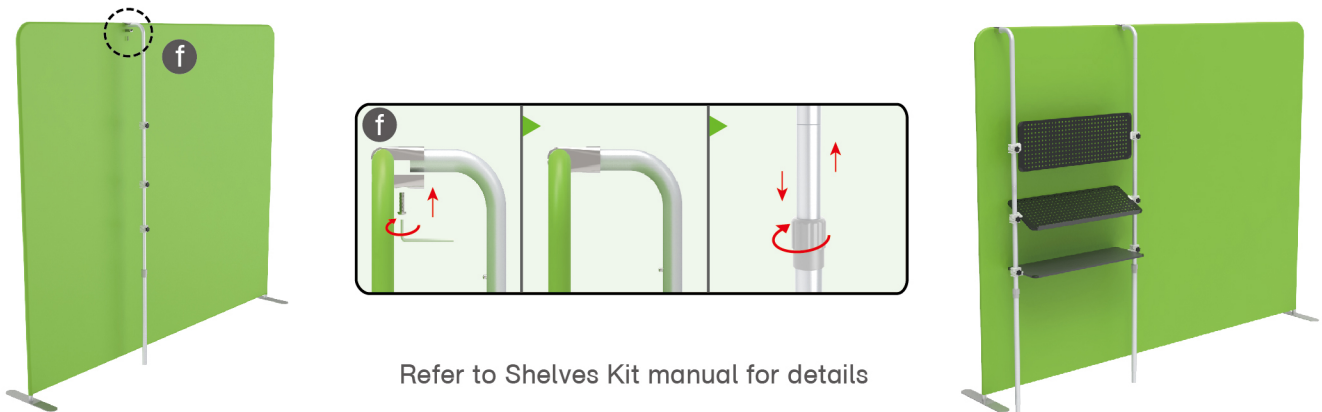

PARTS

STEP 03

To use C clip to connect 2 display stand perfectly

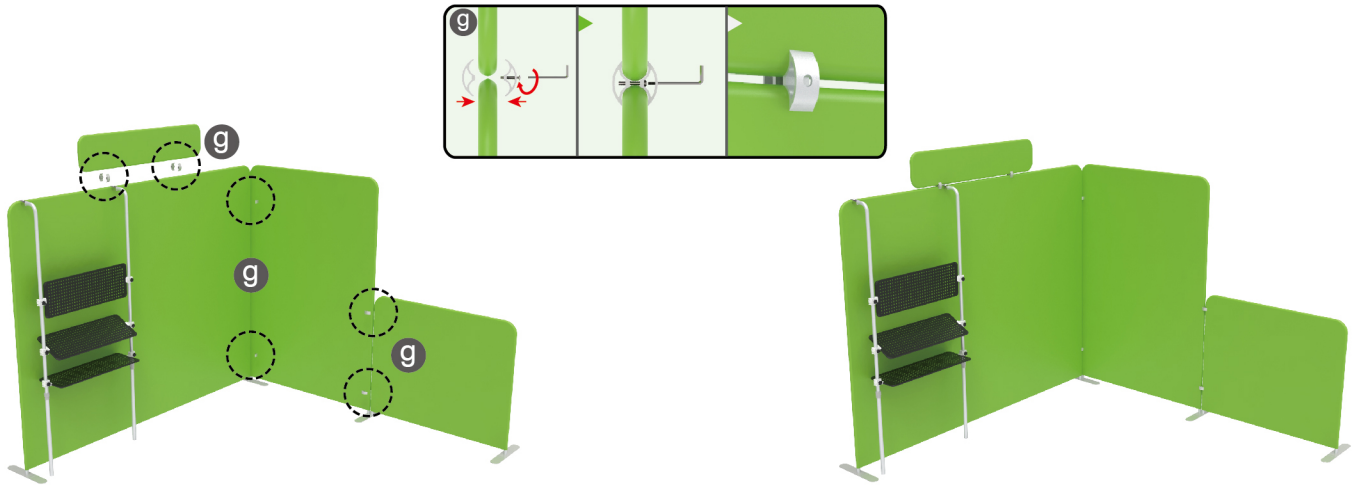

STEP 04

Install LED light

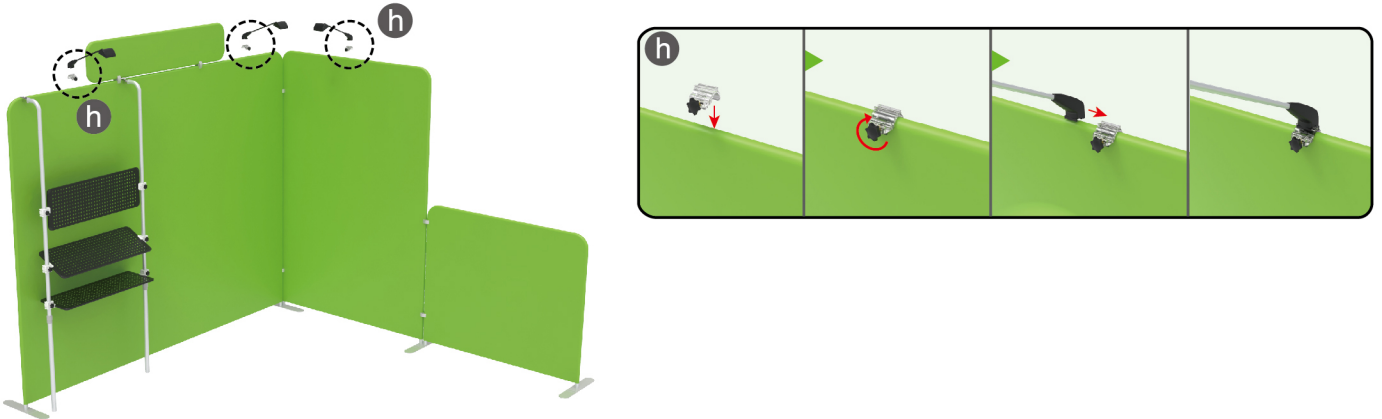

10x10FT-BOOTH-O

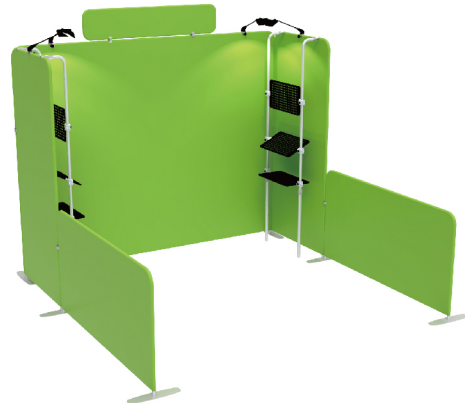

10x10FT-BOOTH-Y