

PARTS

(1) Hardware



(2) Graphic printing fabric banner



STEP 01

To connect the poles according to the labellings

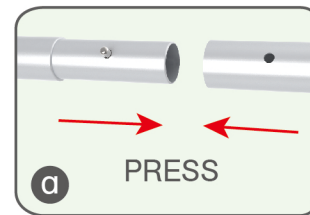
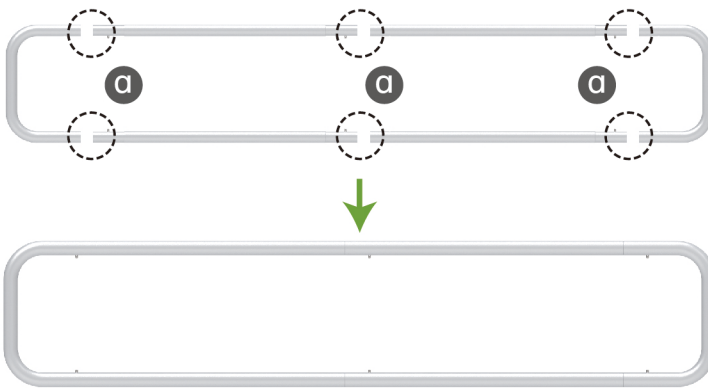

STEP 02

To wrap up the fabric banner from side to side and zip up



Same steps for below style of headers

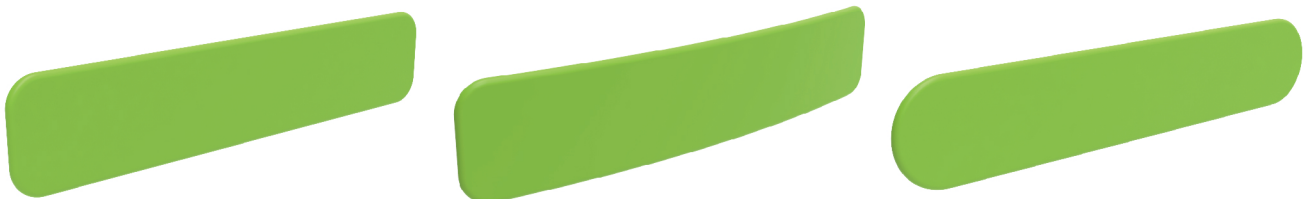

PARTS

(1) Hardware

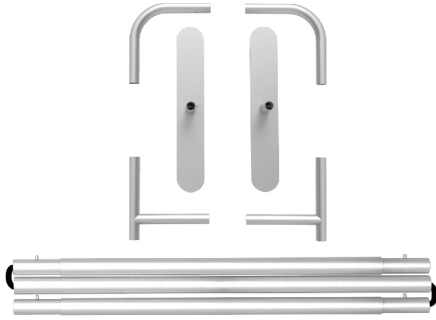

X4

(2) Graphic printing fabric banner

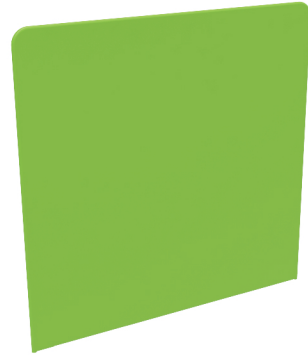

STEP 01

To connect the poles according to the labellings

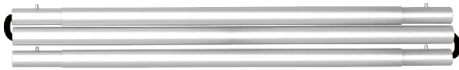

X4

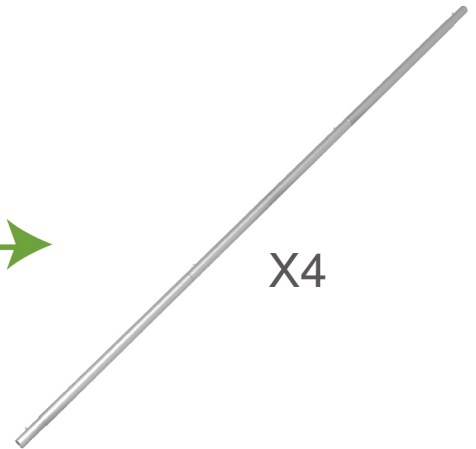
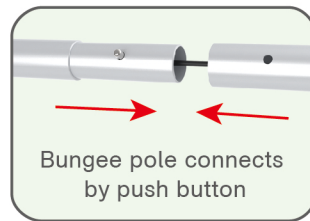

X4

STEP 02

Connect the support poles.

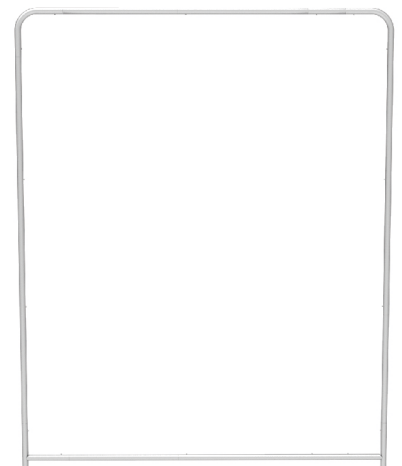
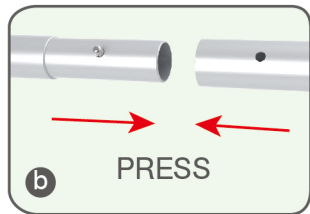
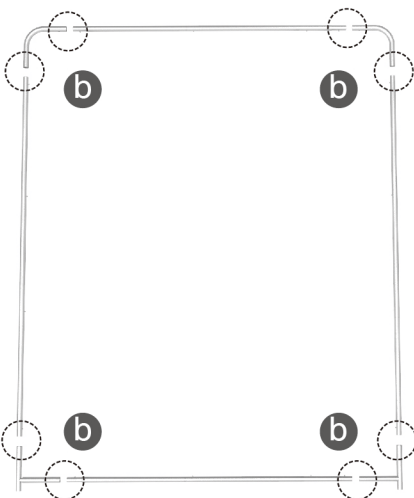

PARTS

STEP 03

To slide the fabric banner on the frame from top and zip up at bottom

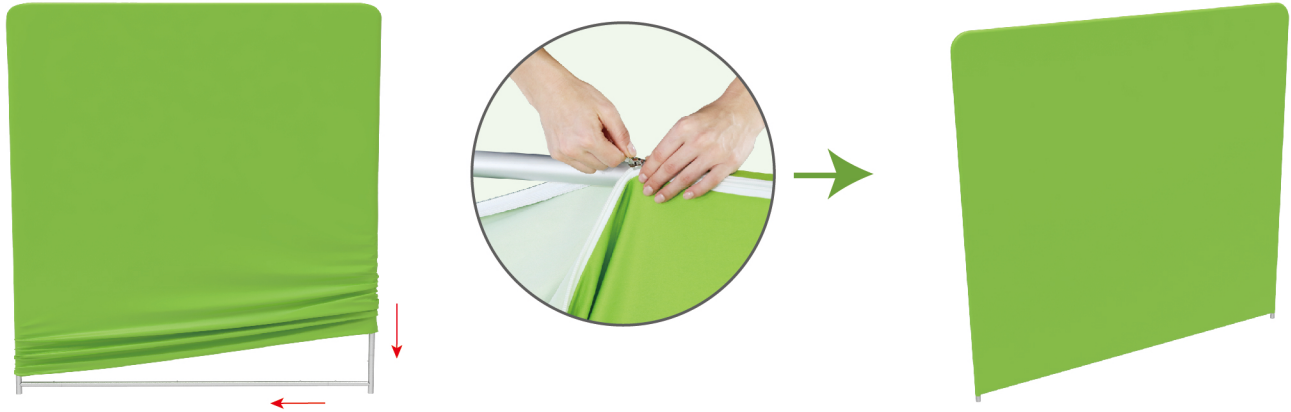

Booth Set Assembly



STEP 01

To install the header onto the back wall by using upright pole

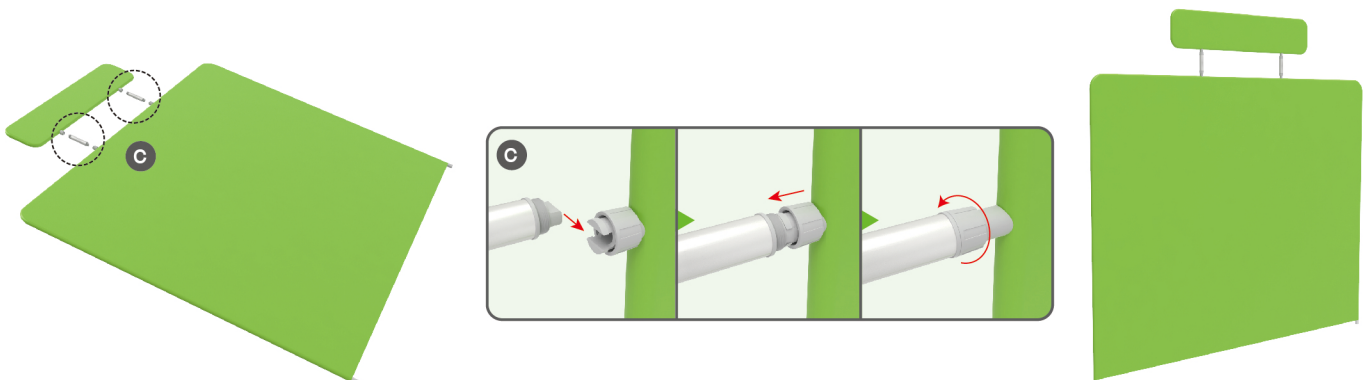

PARTS

STEP 02

To assemble the stand feet in position

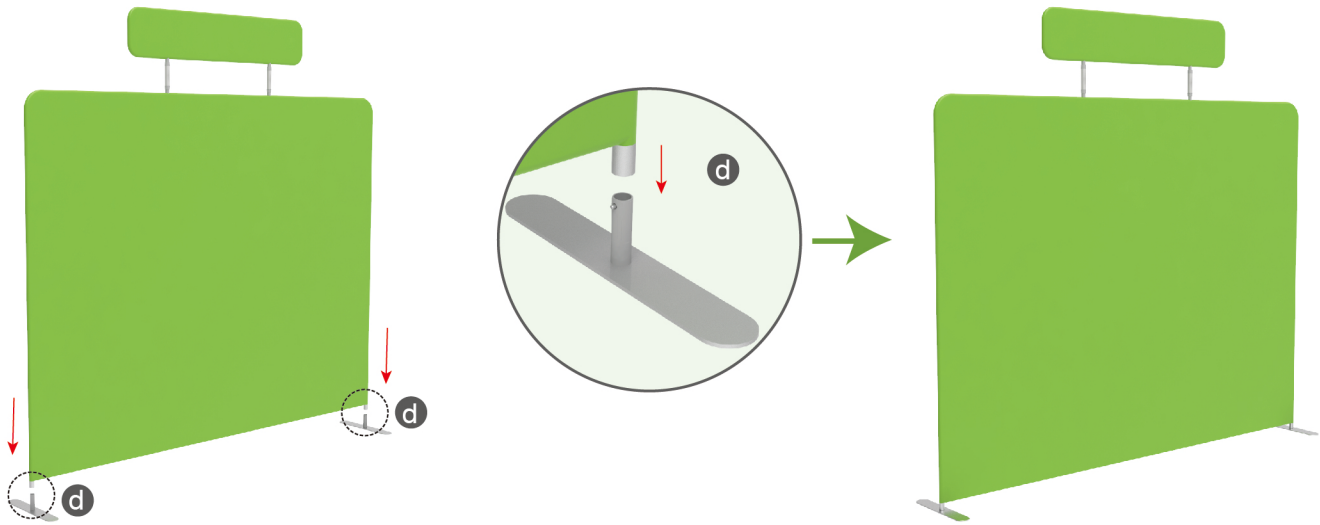

STEP 03

To slide the shelves clips onto the poles and connect the pole to the curved pole head, afterwards loose the screw of clamp a bit then clip the complete pole to the top of backwall, eventually, install the pegboards in position and adjust the height of poles properly

Refer to Shelves Kit manual for details

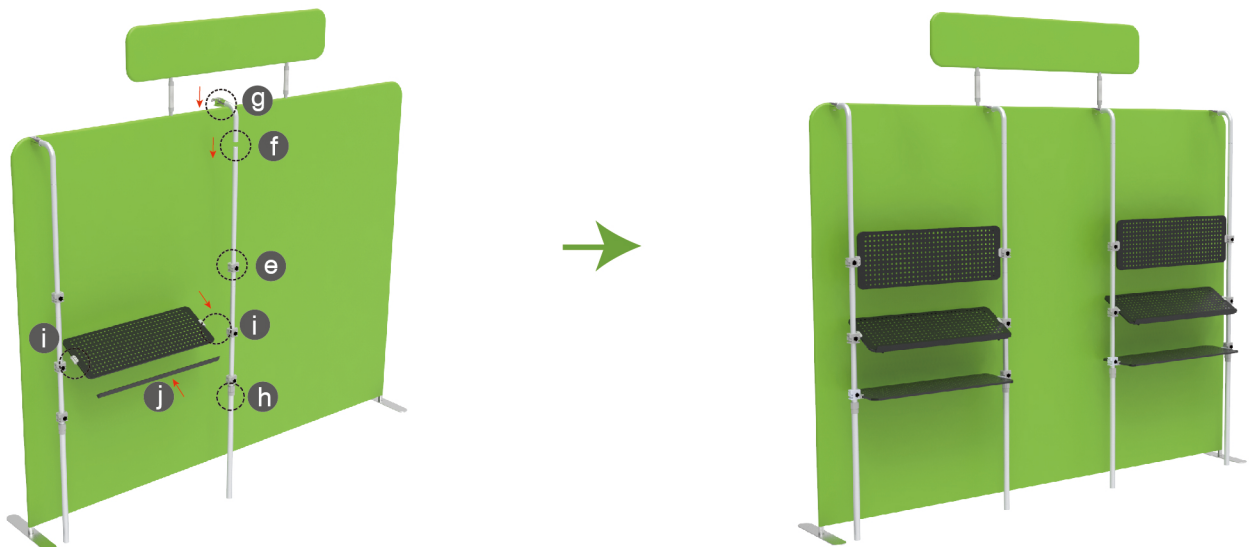
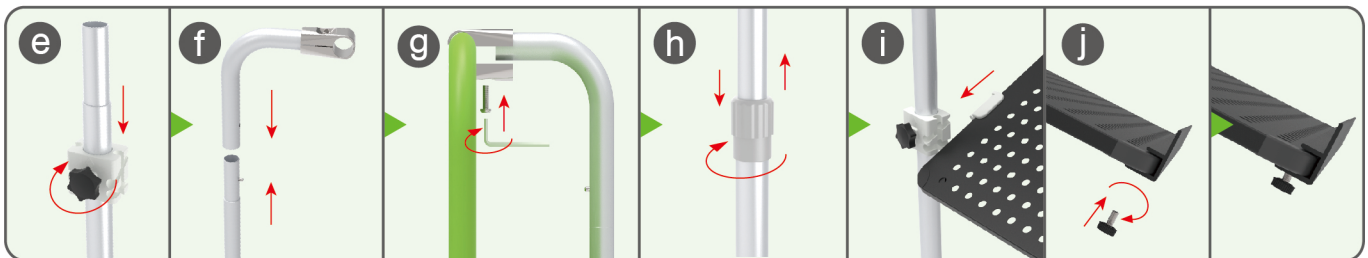

PARTS

STEP 04

Install LED light

